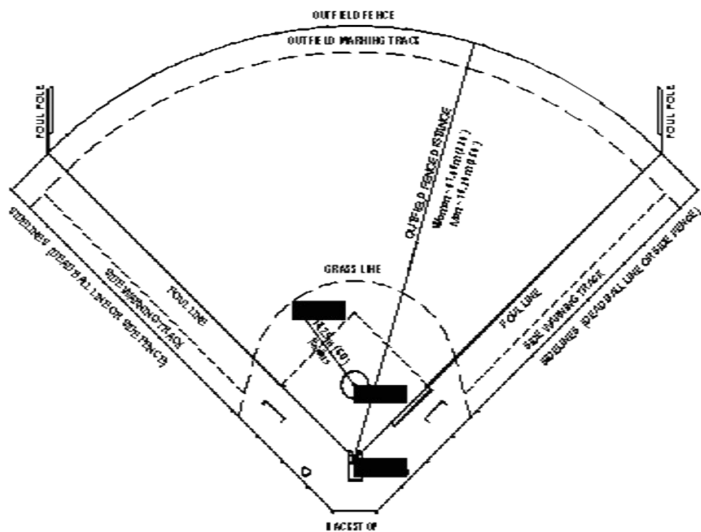

CANADIAN FAST PITCH CHAMPIONSHIP PLAY AGE CATEGORIES & DISTANCE TABLE (FAST PITCH)

CATEGORY	AGE (prior to January 1st of the current year)	BALL	PITCHING	BASELINES	FENCES Min Max.
MALE					
Masters*	40 or over	30.5 cm (12")	14.0 m (46')	18.3 m (60')	68.6 m – 81.0 m (225' - 265')
* In Master Men's Fast Pitch the minimum age limit will be 40 years of age in the year of the event.					
Men's					
U23	Under 23	30.5 cm (12")	14.0 m (46')	18.3 m (60')	68.6 m – 81.0 m (225' - 265')
U20	Under 20	30.5 cm (12")	14.0 m (46')	18.3 m (60')	68.6 m – 81.0 m (225' - 265')
U17	Under 17	30.5 cm (12")	14.0 m (46')	18.3 m (60')	68.6 m – 81.0 m (225' - 265')
U15	Under 15	30.5 cm (12")	12.8 m (42')	18.3 m (60')	64.0 m – 76.2 m (210' - 250')
U13	Under 13	27.95 cm (11")	11.58 m (38')	16.76 m (55')	51.8 m – 68.6 m (170' - 225')
U11	Under 11	27.95 cm (11")	10.67 m (35')	13.7 m (45')	48.5 m – 68.6 m (160' - 225')
U9	Under 9	27.95 cm (11")	9.14 m (30')	13.7 m (45')	48.5 m – 68.6 m (160' - 225')
U7	Under 7	27.95 cm (11")	9.14 m (30')	13.7 m (45')	48.5 m – 68.6 m (160' - 225')
FEMALE					
* In Masters Women's Fast Pitch the minimum age limit will be 35 years of age in the year of the event.					
Women's					
U23	Under 23	30.5 cm (12")	13.1 m (43')	18.3 m (60')	67.1 m – 71.6 m (220' - 235')
U19	Under 19	30.5 cm (12")	13.1 m (43')	18.3 m (60')	61.0 m – 64.0 m (200' - 210')
U17	Under 17	30.5 cm (12")	13.1 m (43')	18.3 m (60')	54.9 m – 64.0 m (180' - 210')
U15	Under 15	30.5 cm (12")	12.2 m (40')	18.3 m (60')	51.8 m – 64.0 m (170' - 210')
U13	Under 13	27.95 cm (11")	11.58 m (38')	16.76 m (55')	48.5 m – 64.0 m (160' - 210')
U11	Under 11	27.95 cm (11")	10.67 m (35')	13.7 m (45')	45.7 m – 64.0 m (150' - 210')
U9	Under 9	27.95 cm (11")	9.14 m (30')	13.7 m (45')	45.7 m – 64.0 m (150' - 210')
U7	Under 7	27.95 cm (11")	9.14 m (30')	13.7 m (45')	45.7 m – 64.0 m (150' - 210')
Orthodox					
MALE		30.5 cm (12")	12.8 m (42')	18.3 m (60')	68.6 m – 81.0 m (225' - 265')
FEMALE		30.5 cm (12")	12.2 m (40')	18.3 m (60')	61.0 m – 64.0 m (200' - 210')
MIXED		30.5 cm (12")	12.8 m (42')	18.3 m (60')	68.6 m – 81.0 m (225' - 265')

Notes: Minor/Youth age categories refer to all categories up to U20 inclusive.

APPENDIX I: PLAYING FIELD AND DIAMOND LAYOUT**A. OFFICIAL DIMENSIONS OF THE PLAYING FIELD**

B. OFFICIAL DIMENSIONS OF THE DIAMOND LAYOUT

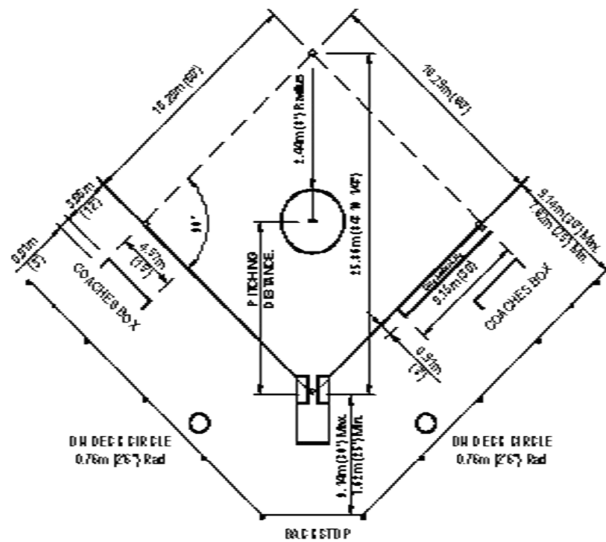

C. OFFICIAL DIMENSIONS OF THE BASES

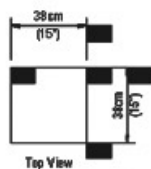

Top View

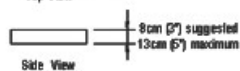

Side View

SECOND AND THIRD
BASE

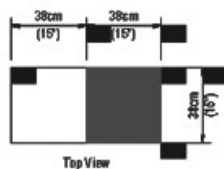

Top View



Side View

FIRST (DOUBLE)
BASE

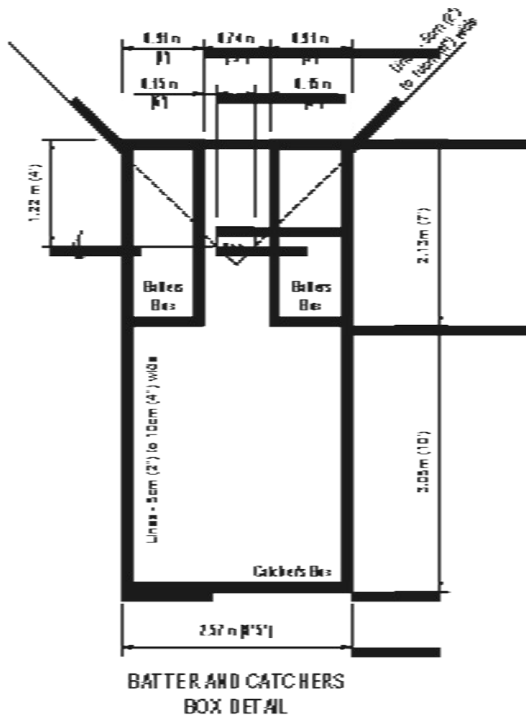
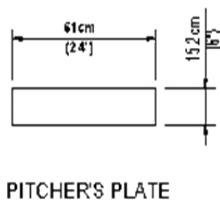
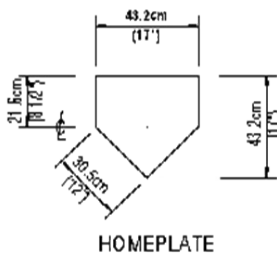
D. OFFICIAL DIMENSIONS OF THE BATTER'S AND CATCHER'S BOXES**E. OFFICIAL DIMENSIONS OF HOME PLATE AND PITCHER'S PLATE**

F. QUICK REFERENCE TABLE

BACKSTOP AND SIDELINES (DEAD BALL LINE/SIDE FENCE)

Will be set back a minimum of 7.62m (25 ft.) to a maximum of 9.14m (30 ft.) outside the foul lines. The area between the foul lines and the backstop and sidelines must be unobstructed.

BASES

Home plate to first/third 18.29m (60 ft.) from the back part of home plate to the back of the base. Home plate to second 25.86m (84 ft. 10 ¼ in) from back point of home plate to the middle of the base. Bases will be made of canvas or other suitable material and securely fastened in position.

First (Double) Base will have half of this base secured in and is part of fair territory and the other half of this base (a different solid contrasting color) is secured in and is part of foul territory.

BATTER'S BOXES

One on each side of home plate will measure 0.91m (3 ft.) by 2.13m (7 ft.). The inside lines of the batter's box will be 15.2cm (6 in) from home plate. The front line of the box will be 1.22m (4 ft.) in front of a line drawn through the center of home plate. The lines are considered as being within the batter's box.

CATCHER'S BOX

3.05m (10 ft.) in length from the rear outside corners of each batter's box and will be 2.57m (8 ft. 5 in) wide. The lines are considered as being within the catcher's box.

COACHES' BOXES

Behind a line 4.57m (15 ft.) long drawn outside the diamond. The line is parallel to and 3.66m (12 ft.) from the first and third baselines, extended from the bases toward home plate.

DISTANCE TABLE

SC: *The distance table is located at the beginning of the Table of Contents.*

HOME PLATE

It will be a five-sided figure 43.2cm (17 in) wide, across the edge facing the pitcher. The sides will be parallel to the inside lines of the batter's box and will be 21.6cm (8 1/2 in) long. The sides of the point facing the catcher will be 30.5cm (12 in) long. *The Plate shall be made of rubber.*

INFIELD

Skinned portion 18.29m (60 ft.) arc from the front center of the pitcher's plate.

LINES

50mm to 100 mm (2 to 4 in) wide.

ON-DECK CIRCLE

1.52m (5 ft.) circle 0.76m (2 ft 6 in) radius placed adjacent to the end of the players' bench or dugout area closest to home plate.

ONE METER LINE

Drawn parallel to and one meter (3 ft.) from the baseline, starting at a point halfway between home plate and first base.

PITCHER'S CIRCLE

4.88m (16 ft.) circle drawn from center of the front edge of the pitcher's plate 2.44m (8 ft.) in radius. The lines are considered within the circle.

PITCHER'S PLATE

Made of *wood* or rubber 61cm (24 in) long and 15.2cm (6 in) wide and the top of the plate must be level with the ground.

WARNING TRACK

Will be a minimum of 3.66m (12 ft.) to a maximum of 4.57m (15 ft.) from the outfield and/or side fences. Made of material (dirt, gravel) that is level with, but different from, the playing surface. The material must be distinguishable from the outfield surface, and there must be a clear physical signal for players when they are approaching the fence.

G. LAYING OUT A DIAMOND

This section serves as an example for laying out of a diamond with 18.29m (60 ft) and a 14.02m (46 ft) pitching distance.

1. To determine the position of home plate, draw a line in the direction it is desired to lay the diamond. Drive a stake at the corner of home plate nearest the catcher. Fasten a cord to this stake and tie knots or otherwise mark the cord at 14.02m (46 ft.), 18.29m (60 ft.), 25.86m (84 ft. 10 ¼ in) and at 36.58m (120 ft.).
2. Place the cord (without stretching) along the direction line and place a stake at the 14.02m (46 ft.) marker. This will be the front line in the middle of the pitcher's plate. Along the same line, drive a stake at the 25.86m (84 ft. 10 ¼ in) marker. This will be the center of second base.
3. Place the 36.58m (120 ft.) marker at the center of second base and, taking hold of the cord at the 18.29m (60 ft.) marker, walk to the right of the direction line until the cord is taut and drive a stake at the 18.29m (60 ft.) marker. This will be the outside corner of first base and the cord will now form the lines to first and second bases.
4. Again holding the cord at the 18.29m (60 ft.) marker, walk across the field and in like manner, mark the outside corner of third base. Home plate, first base, and third base are wholly inside the diamond.
5. To check the diamond, place the home plate end of the cord at the first base stake and the 36.58m (120 ft.) marker at third base. The 18.29m (60 ft.) marker should now check at home plate and second base.
6. Check all distances with a steel tape whenever possible.